



H & HS

Single Action – External Mix – Siphon Feed Airbrushes

OPERATING INSTRUCTIONS AND REPLACEMENT PARTS



WARNING: Spray materials may be harmful if inhaled or allowed to come into contact with the skin or eyes. Consult the product label and Material Safety Data Sheet supplied for the spray material. Follow all safety precautions. **CAUTION:** Well Ventilated Area Required to remove fumes, dust or overspray.
Maximum Air Pressure 75 P.S.I.

INTRODUCTION:

Paasche® model **H** Airbrush features machined Brass Body, Stainless Steel Needle & Nickel Silver Tip and Aircap. The **HS** is the same Airbrush with the added feature of a threaded swivel nut connector for locking the Bottle Assembly in position, thus offering even greater flexibility in movement. The air and color feeds are independent and adjustable to give a fixed line, shade or stipple effect.

OPERATING INSTRUCTIONS:

Approximate Working Pressures:

- 20 lbs. or Less: Stipple and granulated effects, pressure will vary with viscosity of fluid.
- 20 to 30 lbs.: Medium consistency water colors, inks & dyes.
- 30 lbs. or More: Heavy fluids, acrylics, reduced lacquers, varnishes, paints or ceramic glaze.

Sizes:

- Size 1 (.45mm) HT-1, HN-1-3 and HC-1-3 for light fluids.
- Size 3 (.64mm) HT-3, HN-1-3 and HC-1-3 for medium fluids.
- Size 5 (1.06mm) HT-5, HN-5 and HC-5 for heavier fluids.

New Part Notes:

- HC-1-3 now works on both size 1 & 3 Head (HC-5 has five grooves HC-1-3 is unmarked)
- HN-1-3 now works on both size 1 & 3 heads (HN-5 needles are marked with 5 grooves. HN-1-3 needles Have 1 groove & 3 grooves side by side and have a sharper point.)
- We still have three HT tips in size 1, 3 and 5 (Each is marked with 1, 3 or 5 grooves)
- We now machine the needle in Stainless Steel.

Setup Steps:

1. Attach Hose Coupling to the Airbrush.
2. Attach Color Cup or Bottle to HN Needle by exerting a firm twisting motion to fit tapered tube securely into tapered Needle inlet. For HNS fasten swivel nut to threaded coupling on bottle. To remove Color Cup from HN- Needle, exert a backwards twisting pulling motion.

3. Fill Color Cup or Bottle 1/2 to 3/4 full. Use eyedropper or brush for adding small amounts of color to metal color cup. When using Color Bottle, vent hole must be kept open.
4. To Spray, hold Airbrush like a pencil comfortably between thumb and forefinger using middle finger as a guide and support. Like writing, hold forefinger easily on H-155 Finger Button and Press to open air valve.
5. Regulate volume of color and size of spray by rotating HT-1, 3 or 5 Tip clockwise to increase and counter clockwise to decrease flow of color.
6. Stipple Adjustment: Reducing the airline pressure is the easiest method used when creating a stippled effect with the airbrush. Pressure can be reduced by using any of the following items: 3A Needle Valve or the R-75 A Regulator.
7. To adjust for heavier fluids, turn tip wide open, loosen set screw, slide needle back to obtain better flow.

CARE AND CLEANING

1. Pour any remaining color back into its original container.
2. Wipe Color Cup or Bottle clean, using cloth moistened with proper solvent.
3. Hold Airbrush at a downward angle and put a few drops of solvent through the H- or HS- Tip & Needle Assembly. To flush out the remaining color in the H or HS Tip & Needle Assembly, apply pressure to the H-155 Finger Button.

HOW TO OPEN CLOGGED FLUID PASSAGES

1. Placing finger momentarily over HC- Aircap while air is passing through the Airbrush. This will blow color back into bottle thus opening clogged fluid passages. **Do not do this with a cup as color may blow out of cup.**
2. Should the Tip & Needle Assembly become clogged, loosen H-153 Set Screw, unscrew HT Tip from HN- or HNS- Needle, gently pull back through ball-shaped support and remove Tip.
3. Clean Parts carefully, using nothing harder than a wooden toothpick.
4. To reassemble, reverse this procedure, making sure the shoulder of the Needle seats up against ball-shaped support.
5. If the needle and tip are completely clogged, soak in a closed bottle of proper solvent until clean.

Paasche Airbrush Company
 4311 North Normandy Avenue
 Chicago, IL 60634-1395
Phone: 773-867-9191 • **Fax:** 773-867-9198
Website: paascheairbrush.com
E-Mail: info@paascheairbrush.com

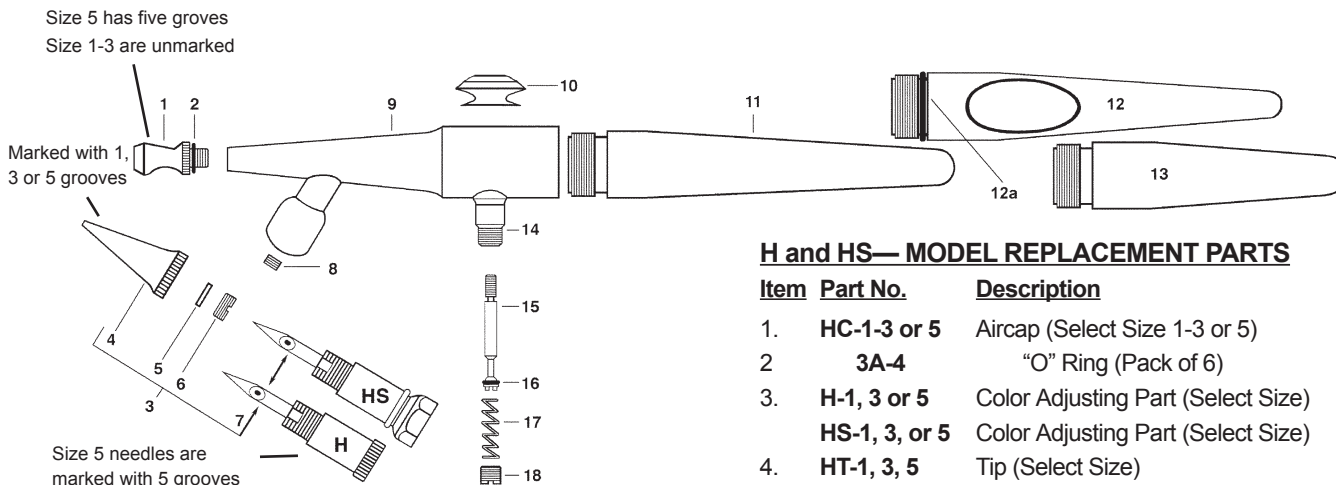

Size 5 has five grooves
Size 1-3 are unmarked

Marked with 1, 3 or 5 grooves

Size 5 needles are marked with 5 grooves and 1-3 needles are marked with 1 & 3 grooves side by side.

The size 1 & 3 Needle and Aircap are now the same part.

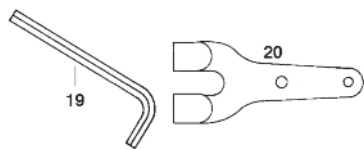

H and HS Airbrush Metal Color Cups, Glass and Plastic Bottle Assemblies

- * Plastic Cover, Metal Tube and Glass Bottle.
- ** Plastic Cover, Tube and Bottle.
- *** Aluminum Cover and Cup.

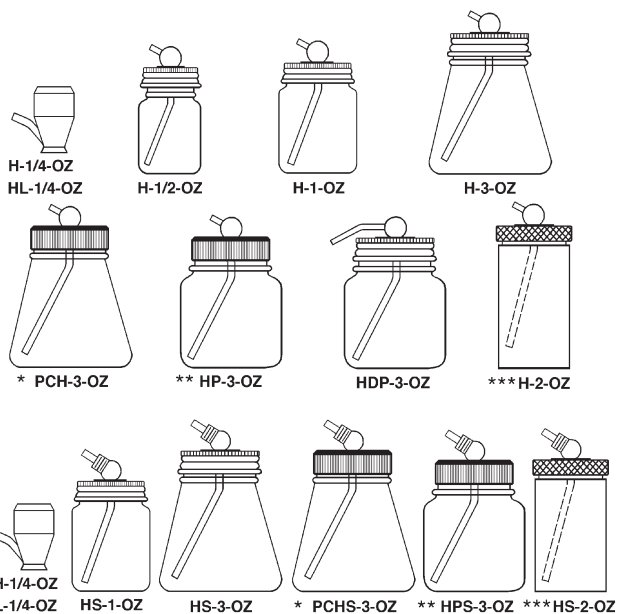

H & HS Airbrush Airhoses with Factory Installed Couplings and replacement Couplings for field installation.

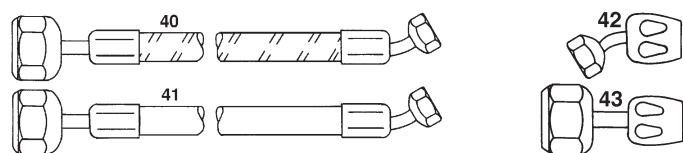

H and HS— MODEL REPLACEMENT PARTS

Item	Part No.	Description
1.	HC-1-3 or 5	Aircap (Select Size 1-3 or 5)
2.	3A-4	"O" Ring (Pack of 6)
3.	H-1, 3 or 5	Color Adjusting Part (Select Size)
	HS-1, 3, or 5	Color Adjusting Part (Select Size)
4.	HT-1, 3, 5	Tip (Select Size)
5.	H-185	Packing
6.	H-184	Nut
7.	HN-1-3 or 5	Needle Assembly (Select HN-1-3 or HN-5)
7.	HNS-1-3 or 5	Needle Assembly (Select HNS-1-3 or HNS-5)
8.	H-153	Set Screw (Stainless Steel)
9.	H-150N	Shell (Includes H-128A)
10.	H-155	Finger Button
11.	H-143	Handle (Nylon)
12.	HVL-202	Metal Handle w/Cut-Out, "O" Ring (Optional)
12a.	VL-224	"O" Ring for HVL-202 Handle
13.	HVL-200	Metal Handle - no cutout
14.	H-128A	Valve Casing
15.	H-192A	Valve Plunger w/ A-53 Valve Washer
16.	A-53	Valve Washer (Pack of 6)
17.	A-22	Valve Spring
18.	A-23R	Air Valve Nut
19.	F-186	Wrench
20.	A-34	Hanger

Cover Assemblies & Gaskets

H1	1oz. H Cover Assembly
HS1	1oz. HS Cover Assembly
H1/2	1/2 oz. H Cover Assem. W/Gasket
H3	3 oz. H Cover Assembly
PCH3	NYLON Cover Assembly
HS3	3 oz. HS Cover Assembly
5-G	1oz. Gasket
3-JG	3 oz. Gasket (Use W/2 oz.)

Air Hoses W/Factory Installed Couplings

40.	A-1/8	Braided Air Hose W/Couplings
	3A-4	"O" Ring
41.	HP-1/8	PVC-Red Plastic Hose W/Couplings
Couplings		
42.	AC-20	1/8"-1/4"-40 Coupling (To Airbrush)
43.	AC-1/8	-1/4" Coupling (To Compressor)